

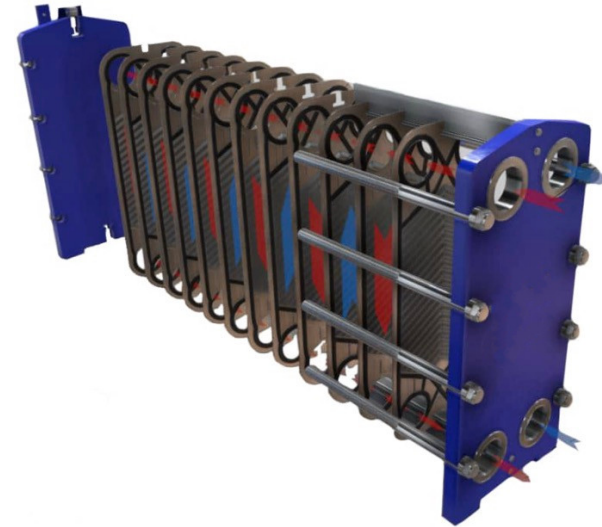

ZBMA10C



Custom Heat Exchangers

Customized gasketed plat-and-frame heat exchangers for efficiency and reliability

Benefits

- Optimal, high-energy efficiency for lowered operating costs
- Flexible configuration with numerous plate and gasket options for high heat recovery
- Hassle-free installation and configuration for heat transfer areas
- High serviceability and easy-to-open design for cleaning and inspection
- Peace of mind with access to Alfa Laval's global service network

Applications

- Biotech and Pharmaceuticals
- Chemicals
- Energy and Utilities
- Food and Beverage
- HVAC
- Machinery
- Marine and Transportation
- Mining, Minerals and Pigment
- Refrigeration
- Semiconductor and Electronics
- Steel
- Water and Waste treatment

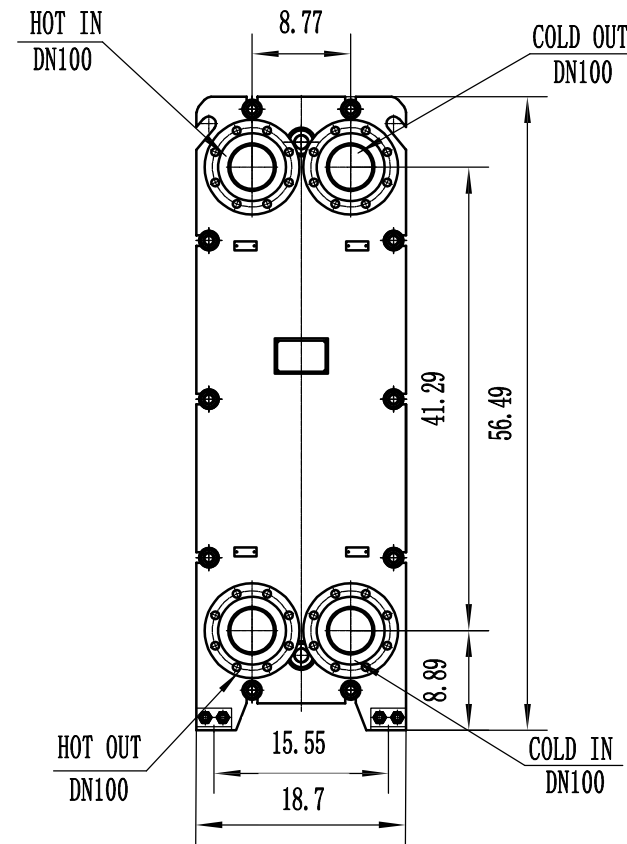
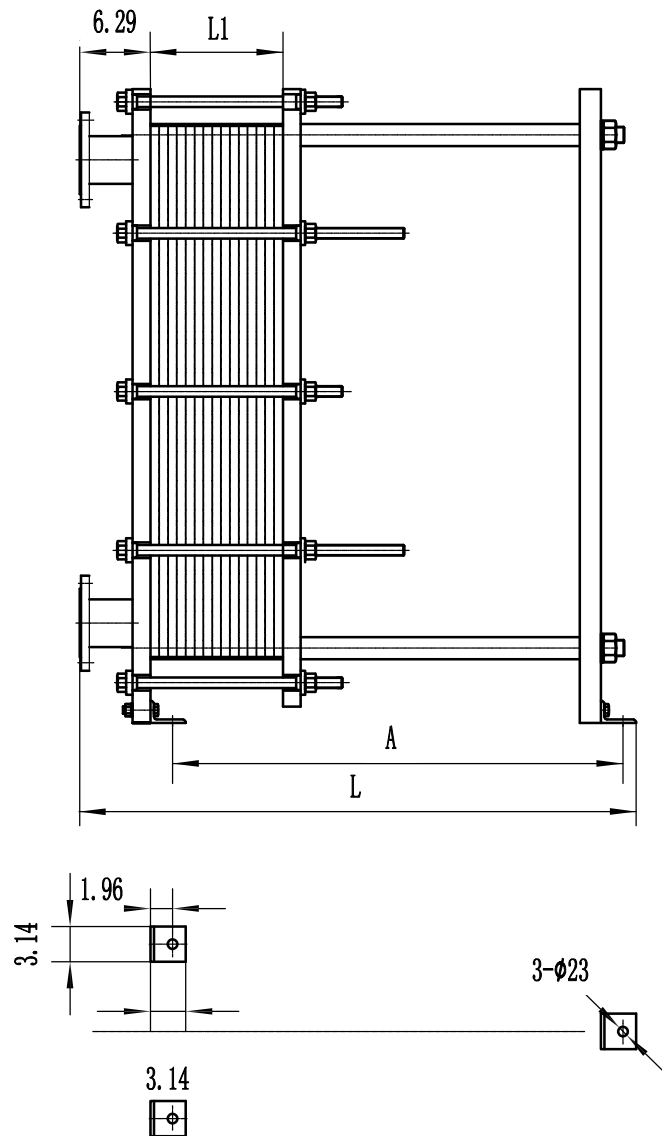

Notes: 1. PLATE HEAT EXCHANGERS SHALL BE DESIGNED, MANUFACTURED, AND ACCEPTED IN ACCORDANCE WITH NB/T47004-2017.

2. FLANGES ACCORDING TO JN/T81-2015.

HEAT EXCHANGE AREA	10	13	15	18	20	25	30	35	40	45	50
NUMBER OF PLATES (Np)	25	33	37	45	51	63	75	87	101	113	125
L (in)	28.34	30.91	31.88	33.66	35.43	38.97	42.51	46.06	49.61	53.14	56.69
L ₁ (in)	4.41	5.82	6.53	8.74	9.01	11.14	13.26	15.39	17.87	20	22.12
A (in)	18.89	21.45	22.44	24.21	25.98	29.52	33.07	36.61	40.15	43.7	47.24
WEIGHT (Kg)	525	545	555	575	590	620	650	680	720	750	780

ZBMA10C											
REV.	ITEM	DESIGNATION	SIGNATURE	DATE	DRAWING REV.		WEIGHT	SCALE			
DESIGNED		STANDARDIZED APPR									
CHECKED		FINAL APPR									
APPROVED		APPROVAL									
TECHNICAL MGMT		DATE			TOTAL	SHEET	SHEET	OF			