

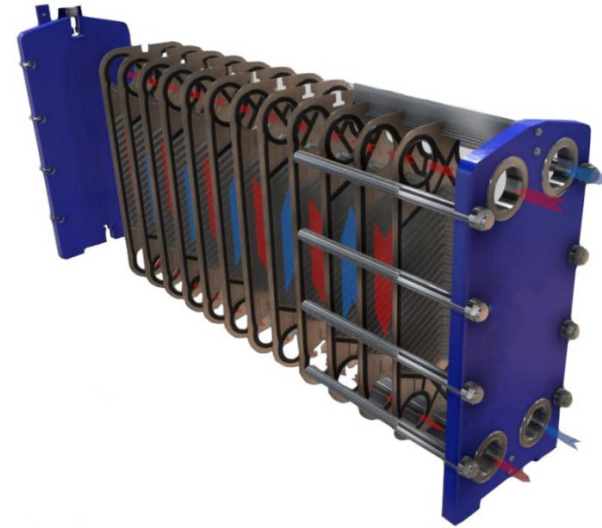

ZBM20



Custom Heat Exchangers

Customized gasketed plat-and-frame heat exchangers for efficiency and reliability

Benefits

- Optimal, high-energy efficiency for lowered operating costs
- Flexible configuration with numerous plate and gasket options for high heat recovery
- Hassle-free installation and configuration for heat transfer areas
- High serviceability and easy-to-open design for cleaning and inspection
- Peace of mind with access to Alfa Laval's global service network

Applications

- Biotech and Pharmaceuticals
- Chemicals
- Energy and Utilities
- Food and Beverage
- HVAC
- Machinery
- Marine and Transportation
- Mining, Minerals and Pigment
- Refrigeration
- Semiconductor and Electronics
- Steel
- Water and Waste treatment

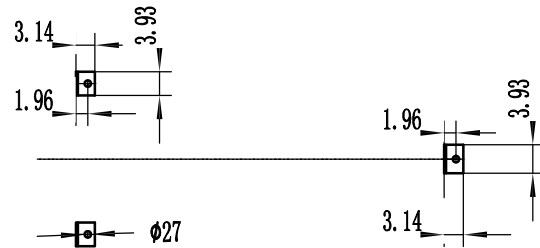
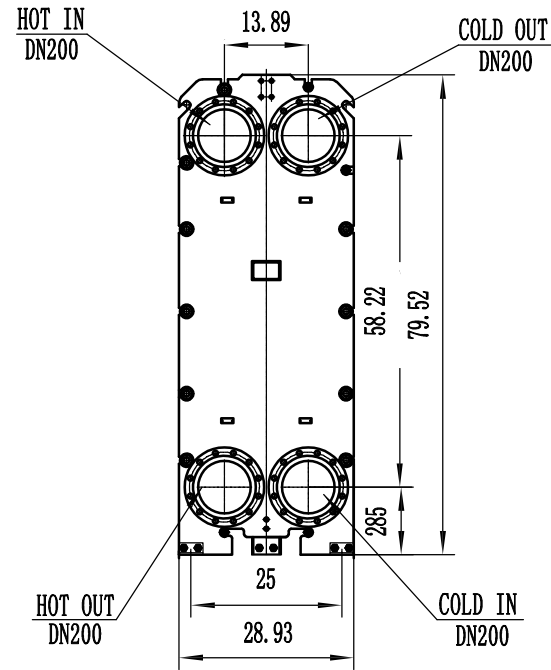
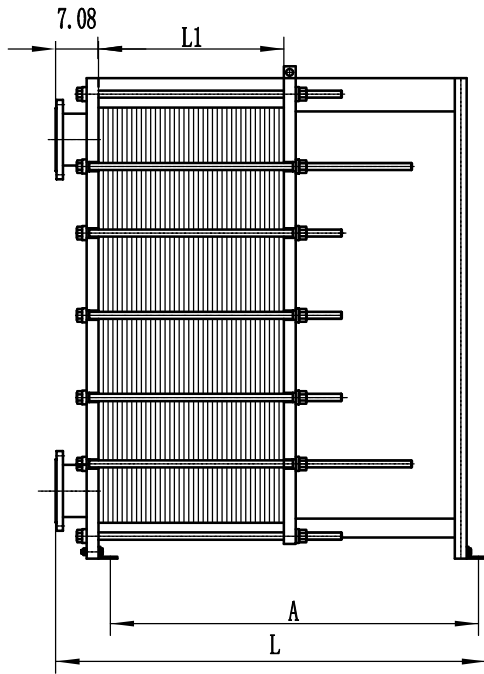

Notes: 1. PLATE HEAT EXCHANGERS SHALL BE DESIGNED, MANUFACTURED, AND ACCEPTED IN ACCORDANCE WITH NB/T47004-2017.
2. FLANGES ACCORDING TO JN/T81-2015.

HEAT EXCHANGE AREA	50	60	70	80	90	100	110	120	130	140	150	160	170
NUMBER OF PLATES (Np)	55	65	77	89	97	109	119	131	141	153	163	173	185
L (in)	42.91	45.86	48.81	51.77	54.72	57.67	60.62	63.58	66.53	69.48	72.44	75.39	78.34
L1 (in)	9.96	11.49	13.62	15.74	17.16	19.29	21.06	23.22	25	27.08	28.74	30.71	32.67
A (in)	32.67	35.62	38.58	41.33	44.48	47.44	50.39	53.34	56.29	59.25	62.21	65.15	68.11
WEIGHT (Kg)	1500	1555	1620	1685	1730	1795	1850	1915	1970	2030	2090	2140	2205

HEAT EXCHANGE AREA	180	190	200	210	220	230	240	250
NUMBER OF PLATES (Np)	195	207	217	229	239	251	261	271
L (in)	81.29	84.25	87.21	90.15	93.11	96.06	99.01	101.96
L1 (in)	35.03	36.61	38.38	40.55	42.32	44.48	46.25	48.03
A (in)	71.06	74.01	76.96	79.92	82.87	85.82	88.77	91.73
WEIGHT (Kg)	2260	2325	2380	2445	2500	2565	2620	2675

REV.	ITEM	DESCRIPTION	SIGNATURE	DATE	ZBM20			
DESIGNED		STANDARDIZED APPR			DRAWING REV.	WEIGHT	SCALE	
CHECKED		FINAL APPR						
APPROVED		APPROVAL						
TECHNICAL AID		DATE			TOTAL SHEET	SHEET	OF	