

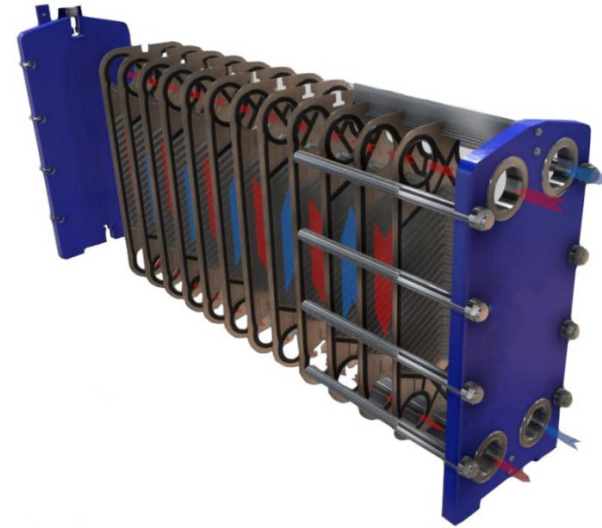

## ZBM15A



## Custom Heat Exchangers

Customized gasketed plat-and-frame heat exchangers for efficiency and reliability

### Benefits

- Optimal, high-energy efficiency for lowered operating costs
- Flexible configuration with numerous plate and gasket options for high heat recovery
- Hassle-free installation and configuration for heat transfer areas
- High serviceability and easy-to-open design for cleaning and inspection
- Peace of mind with access to Alfa Laval's global service network

### Applications

- Biotech and Pharmaceuticals
- Chemicals
- Energy and Utilities
- Food and Beverage
- HVAC
- Machinery
- Marine and Transportation
- Mining, Minerals and Pigment
- Refrigeration
- Semiconductor and Electronics
- Steel
- Water and Waste treatment

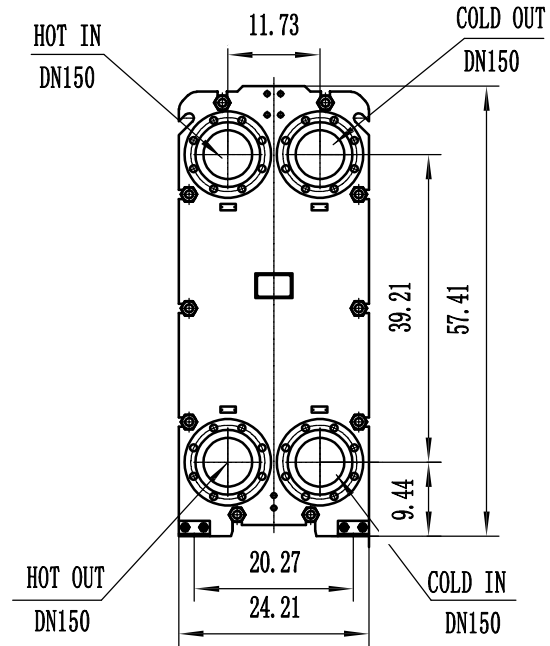
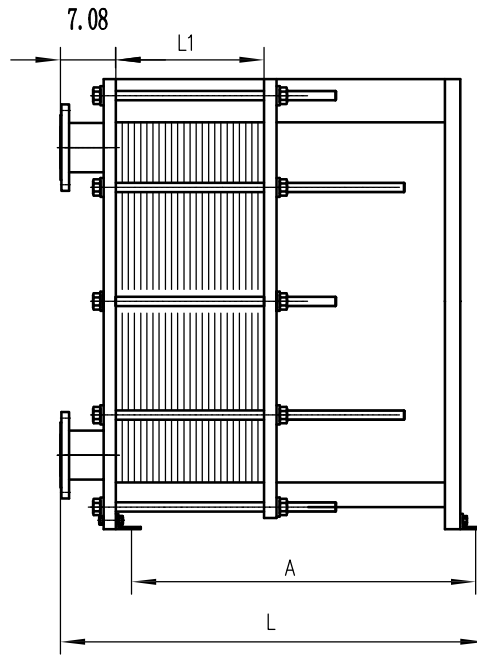

HEAT EXCHANGE AREA (m <sup>2</sup> )	30	40	50	60	70	80	90	100	110	120
NUMBER OF PLATES (N <sub>p</sub> )	55	73	91	109	127	145	163	181	201	219
L (in)	36.22	40.94	45.66	50.39	55.11	59.84	64.56	69.29	74.01	78.74
L1 (in)	9.96	13.18	16.45	19.68	22.99	26.25	29.52	32.75	36.37	39.64
A (in)	25.98	30.71	35.43	40.15	44.88	49.61	54.33	59.05	63.77	68.51
WEIGHT (Kg)	805	855	905	955	1005	1055	1105	1155	1210	1260

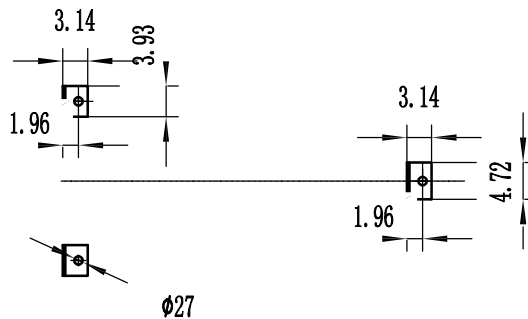

Notes: 1. PLATE HEAT EXCHANGERS SHALL BE DESIGNED, MANUFACTURED, AND ACCEPTED IN ACCORDANCE WITH NB/T47004-2017.

2. FLANGES ACCORDING TO JN/T81-2015.

					ZBM15A			
REV.	ITEM	DESCRIPTION	SIGNATURE	DATE	DRAWING REV.		WEIGHT	SCALE
DESIGNED		STANDARDIZED APPR						
CHECKED		FINAL APPR						
APPROVED		APPROVAL						
TECHNICAL AID		DATE			TOTAL SHEET	SHEET	OF	